

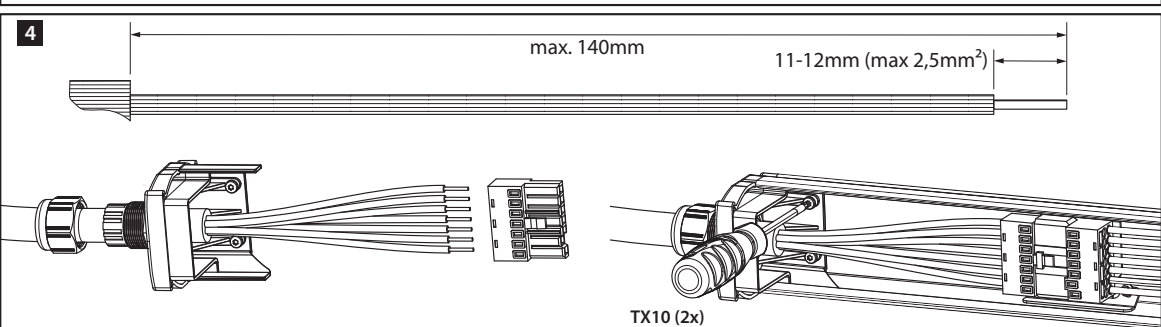

| Version:      | Circuit breaker | Maximum number of fixtures on 1 phase |        |
|---------------|-----------------|---------------------------------------|--------|
|               |                 | Type B                                | Type C |
| L1 3.500lm/m  | 16 A            | 33                                    | 50     |
| L2 3.500lm/m  | 16 A            | 20                                    | 38     |
| L1 7.000lm/m  | 16 A            | 20                                    | 38     |
| L2 7.000lm/m  | 16 A            | 16                                    | 26     |
| L1 10.000lm/m | 16 A            | 20                                    | 38     |
| L2 10.000lm/m | 16 A            | 12                                    | 20     |

Due to the in-flow current, the number of fixtures that can be connected per phase is limited. Before installation, check the table above and the label on the fixture.

**The power must be switched off during installation or maintenance.**

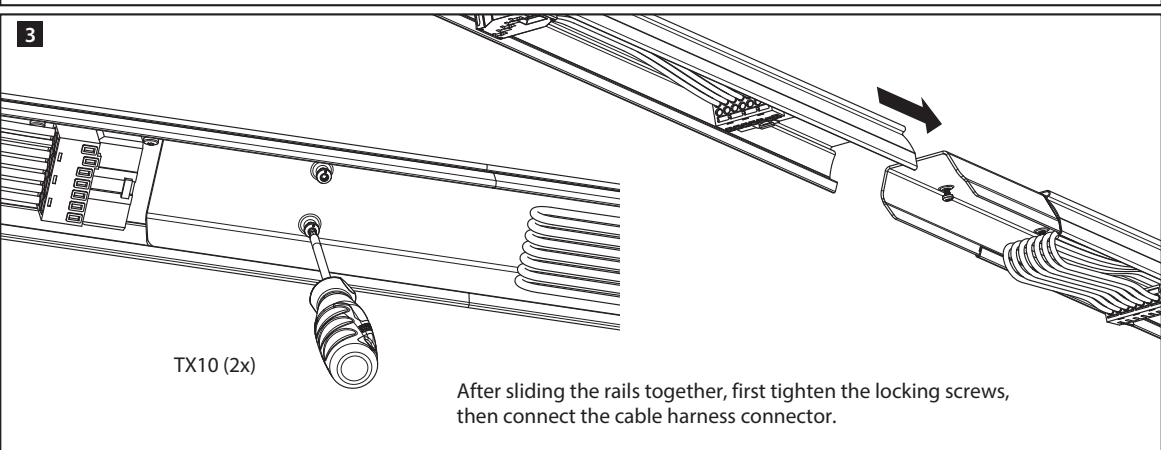
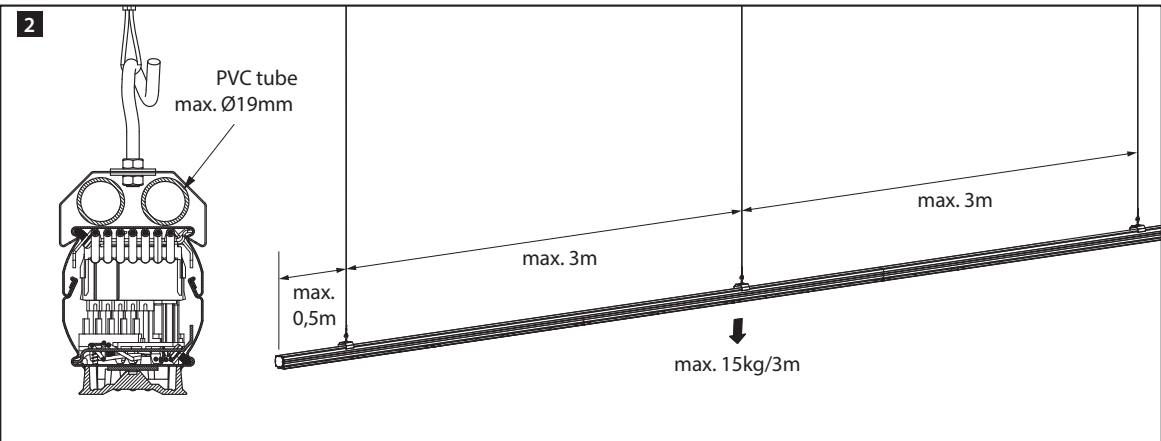
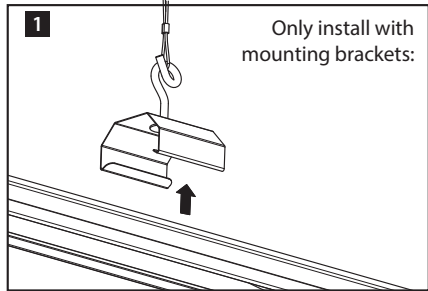

**TLS STARTKIT**

Install the starting cap with the gland, tighten the locking screws and feed the thread. Strip 12mm cables (5 or 7 cores) and insert them into the supplied connector, tighten the gland. Connect the starter connector to the wiring harness.



**5** Before installing the luminaires: remove the IP50 clip and lift the fall protection.

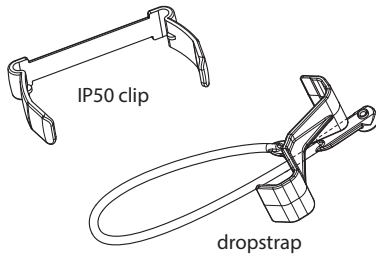

**6** Select the correct phase on the connector for the respective luminaire by sliding the contact pin:

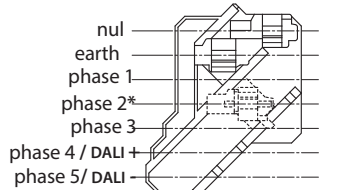

\*or constant voltage for emergency lighting

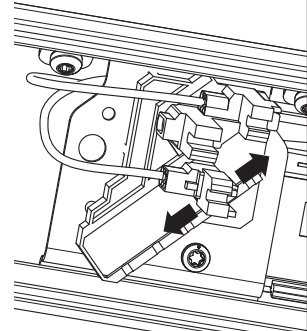

**7**

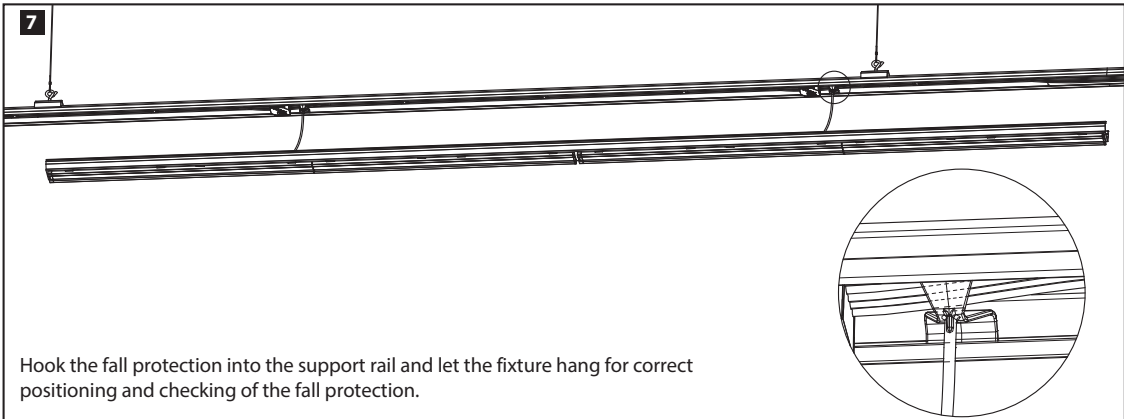

Hook the fall protection into the support rail and let the fixture hang for correct positioning and checking of the fall protection.

**8** Click the fixture into the correct position by aligning the highest pin on the fixture's connector with the connector in the mounting rail.

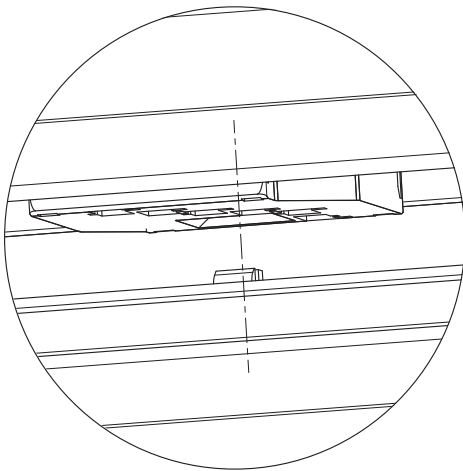

**9**

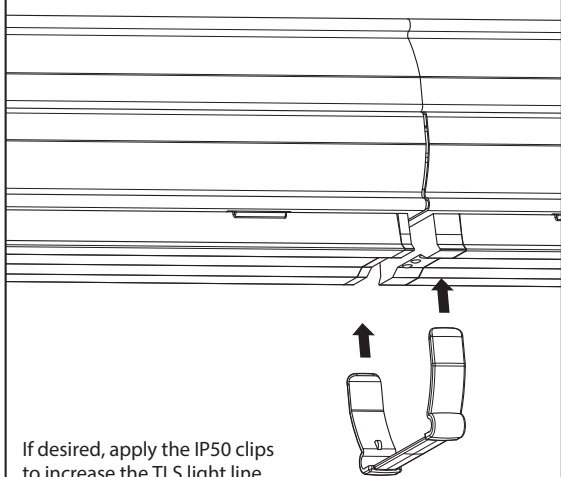

If desired, apply the IP50 clips to increase the TLS light line from IP20 to IP50.

The installation is ready, switch on the mains voltage **per phase** for checking.

NB!

The fixture may only be installed by a qualified electrical installer in accordance with the applicable guidelines and regulations. It is not permitted to place the fixture under voltage.

At the end of its lifespan, present the fixture to the designated authorities for disassembly and recycling of all components.